

COMMERCIAL DUTY

HEAVY DUTY

EXTREME DUTY

FIRE RATED

20 MIN ___ 30 MIN ___ 45 MIN ___
60 MIN ___ 90 MIN ___

WIND LOAD RATED
DESIGN PRESSURE ___ PSF

BLAST LOAD RATED
DESIGN PRESSURE ___ PSF

COLOR

POLAR WHITE

CASHEW TAN

MIST GRAY

PRIMER

OTHER _____

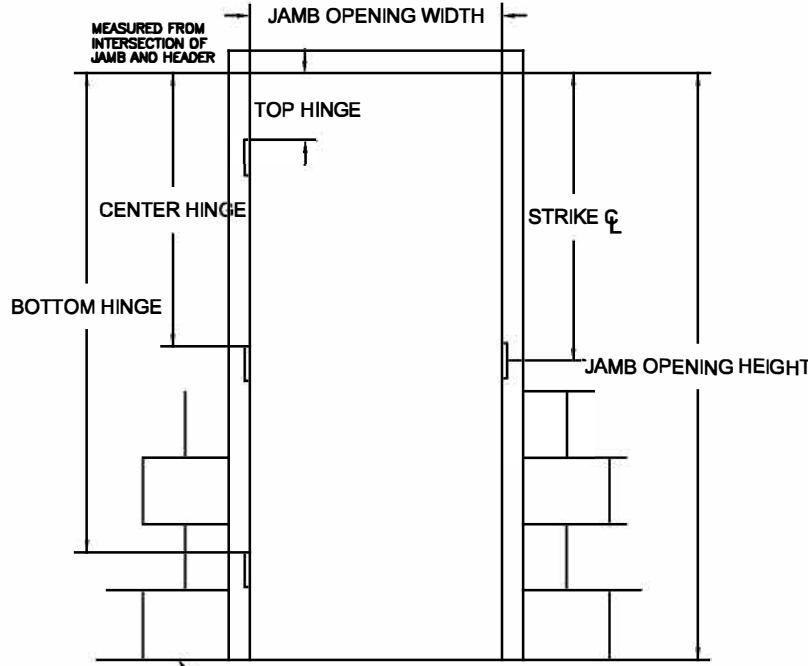

FINISHED FLOOR

JAMB OPENING SIZE

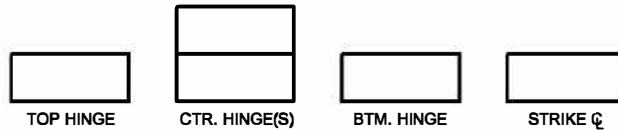

ROUGH OPENING:
OVERALL FRAME PLUS 1/4" ALL AROUND TO ALLOW FOR FRAME SHIMS.

HARDWARE PREPARATIONS

- 4-1/2" MORTISE HINGES
 - 3 4 5
- 5" MORTISE HINGES
 - 3 4 5
- CONTINUOUS HINGE *
- 4-7/8" ANSI STRIKE
- DEADBOLT STRIKE *
- RIM SURFACE STRIKE
- CLOSER
- SURFACE OH HOLDER/STOP
- CONCEALED OH HOLDER/STOP*
- OTHER *

*MAKE & MODEL REQUIRED

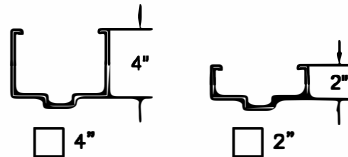

HEAD HEIGHT

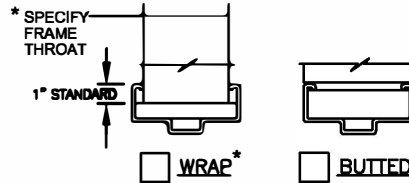

FRAME CONFIGURATION

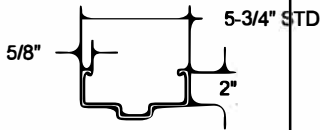

JAMB/FACE DEPTH

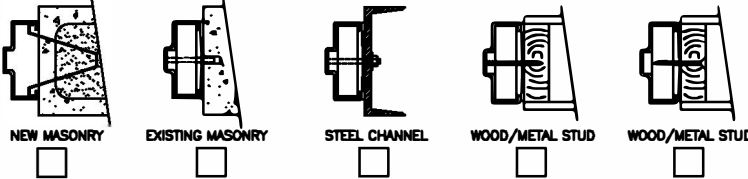

WALL TYPE

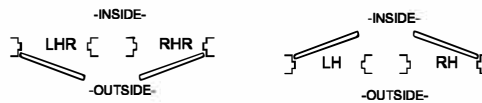

800.828.3655

CUSTOMER NOTES: _____

SINGLE FRAME ONLY

CUSTOMER: _____

PROJECT: _____

DOOR MARK: _____