

- HEAVY DUTY
- EXTREME DUTY

FIRE RATED

20 MIN 30 MIN 45 MIN
 60 MIN 90 MIN

WIND LOAD RATED

DESIGN PRESSURE _____ PSF

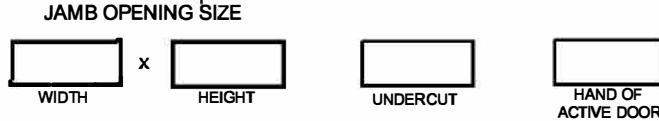
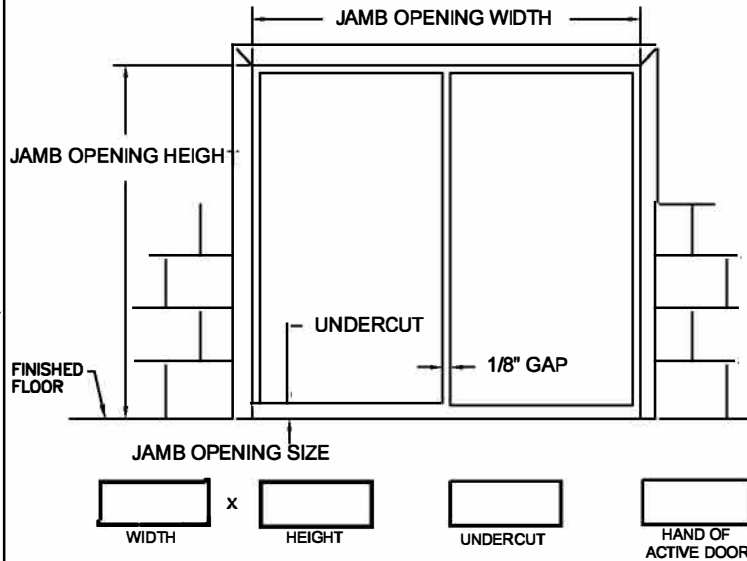

ROUGH OPENING:
 OVERALL FRAME PLUS 1/4\"/>

ELIASON STANDARD HARDWARE LOCATIONS WILL BE PROVIDED UNLESS CUSTOMER SPECIFIES OTHERWISE.

COLOR

- POLAR WHITE
- CASHEW TAN
- MIST GRAY
- PRIMER
- OTHER _____

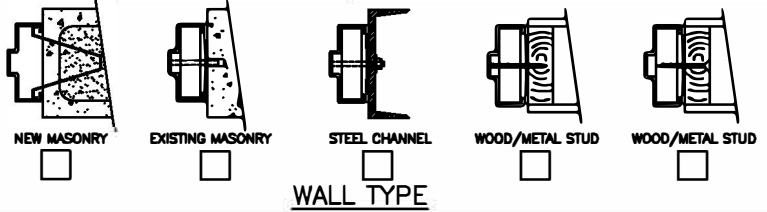
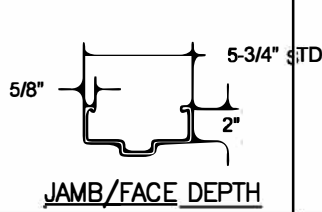
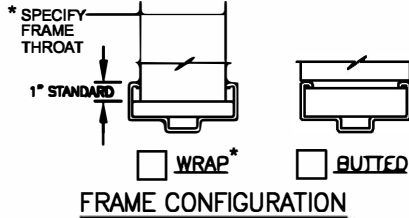
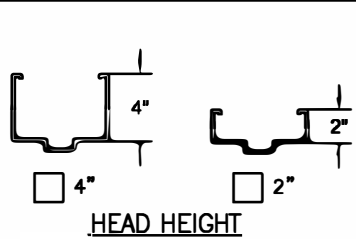

HARDWARE PREPARATIONS AND REINFORCEMENTS

- 4-1/2" MORTISE HINGES 3 4 5
- 5" MORTISE HINGES 3 4 5
- CONTINUOUS HINGE REIN.
- CYLINDRICAL 161 LOCK
- CYLINDRICAL DEADBOLT
- MORTISE DEADLOCK.
- MORTISE 86 LOCK
- MORTISE EXIT DEVICE
- RIM EXIT DEVICE
- SVR EXIT DEVICE
- CVR EXIT DEVICE *
- CLOSER REIN.
- PUSH/PULL PLATES REIN.
- SURFACE OH HOLDER/STOP REIN.
- CONCEALED OH HOLDER/STOP
- SURFACE DOOR BOTTOM REIN.
- CONCEALED DOOR BOTTOM *
- MANUAL FLUSH BOLTS
- AUTOMATIC FLUSH BOLTS * (wood type for UL rated)
- FRP ASTRAGAL
- Installed on INA leaf STD
- OTHER*

*MAKE & MODEL REQUIRED

STANDARD 1/4" GLASS SIZES:

- 8 x 30 (6-1/2 x 28-1/2 VISIBLE)
- 12 x 12 (10-1/2 x 10-1/2 VISIBLE)
- 24 x 24 (22-1/2 x 22-1/2 VISIBLE)
- 24 x 30 (22-1/2 x 28-1/2 VISIBLE)

GLAZING TYPE AND THICKNESS:

- 1/4" TEMPERED
- 1/4" WIRE
- 1/4" LEXAN
- CUTOUT ONLY (NO KIT)
- OTHER _____

CUSTOM SIZES:

VISIBLE WIDTH _____
 VISIBLE HEIGHT _____
 TOP TO VISIBLE _____
 EDGE TO VISIBLE _____
 CENTER HORIZONTALLY

GLAZING:

- BY ELIASON BY OTHERS ACTIVE LEAF INACTIVE LEAF

VISION LIGHT

CUSTOMER NOTES: _____

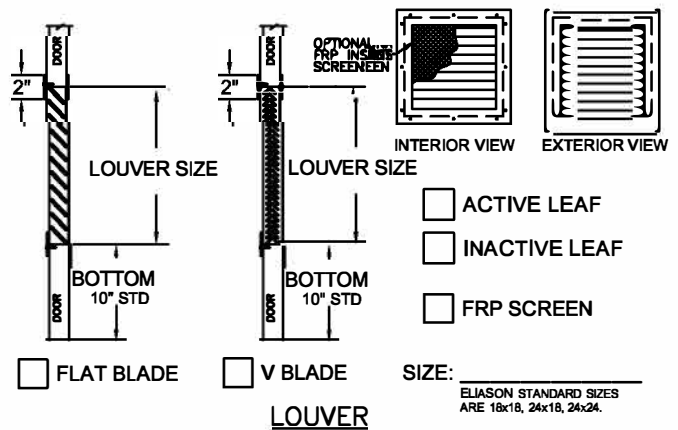
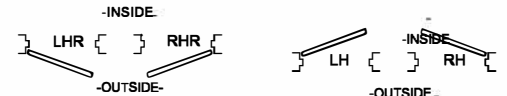

DOUBLE DOOR AND FRAME

CUSTOMER: _____
 PROJECT: _____
 DOOR MARK: _____



800.828.3655